

Certificate no. 4001132

TB205
PRODUCT DATA
054/212596
PA05/05325

Whitting Valley Road, Old Whittington, Chesterfield, Derbyshire S41 9EY UK
 Telephone: +44 (0) 1246 264260 Fax: +44 (0) 1246 455281
 Web: www.trans-tronic.co.uk E mail: sales@trans-tronic.co.uk

COIL WINDING – TRANSFORMER DESIGN & MANUFACTURE

Description:	Class II Hybrid Transformer Rectifier for Point Machines NR/L2/SIG/30007 BR865 type A 230/120v @ 2.5A DC
--------------	---



Dimensions	405x270x 200mm high	Weight	19Kg	Colour	BS381c shade 632 Dark Admiralty Grey
General arrangement drawing	GA-TB205 overleaf	O&M Manual:	Trans-Tronic ClassII-Hybrid Point machine Tj		
Primary (Input) ClassII	T0-T215-T230-T245	Output ClassI	B120 N120 with ±4v taps	2.5A continuous	
Primary terminals	Screw up clamp 0.5 -6mm ²	Secondary terminals	Screw up clamp	0.5-10mm ²	
Functional earth	Screw up clamp 0.5-10mm ²	Enclosure	IP32		
Suitable for driving 1x style 63 point motors , 1 x HW2xxx series, 1 x HPSS point motors, 2 x clamp lock point motors					
Primary resistance 1.4ohms @ 230V Primary Inductance 2.9mH		Secondary resistance 0.4410 ohms Secondary Inductance 1.2mH			
Duty cycle 1 35A surge for 0.1 seconds 15A clutch slipping 0.4 seconds 10A Drive for 10 seconds Every 1 minutes		Duty cycle 2 35A surge for 0.1 seconds 20A clutch slipping 0.4 seconds 10A Drive for 10 seconds Every 2 minutes		Duty cycle 3 35A surge for 0.1 seconds 20A clutch slipping 0.4 seconds 12A Drive for 10 seconds Every 3 minutes	
Input current at 230V 1.79A @ 2.5A Continuous Output 7.3A @ 10A Drive Output 14.4A @ 20A Clutch slipping Output		Output Voltage No load <134V 10A DC Output 120±2V 20A DC Output >110V			
Peak inrush current 9.7x FLC (71A at 230V)		I ² t 38 ² s		X/R ratio 0.35	
Insulation resistance (500v) Primary to body >100M ohms Secondary to body >100M ohms Primary to secondary >100M ohms		Dielectric strength Primary to body 3.8Kv Secondary to body 2.8Kv Primary to secondary 3.8Kv		Impulse withstand 8Kv	
Recommended fuse Protection BS88 & 10x38gG IEC 60269-1 & 2 10A					
Operational temperature range -20°C to +60°C		Humidity Up to 100% RH			
Altitude <2000 metres above sea level		Issue 3 01/08/2013			

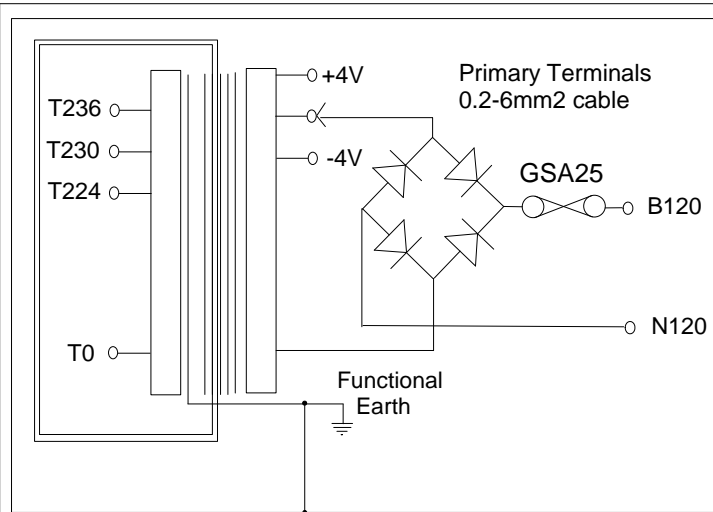

CASE Case 1 Cover 1

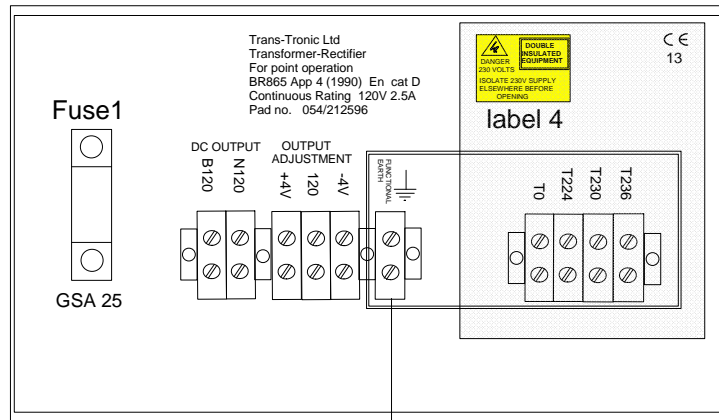

Internal view with case lid removed

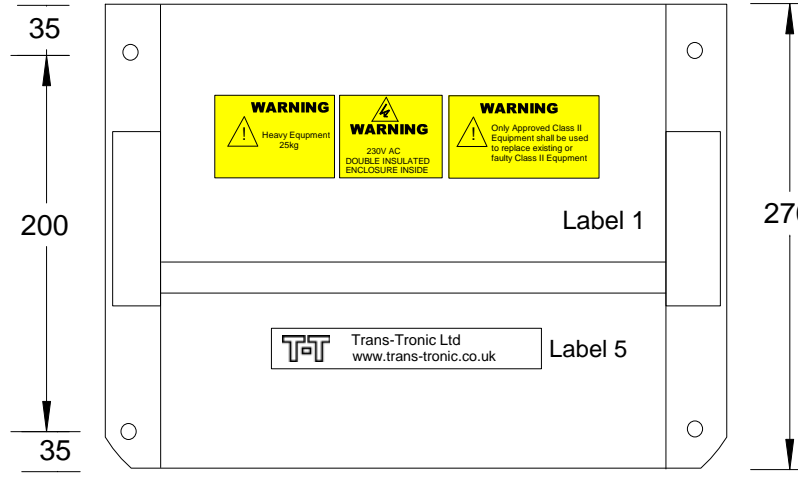

Top view

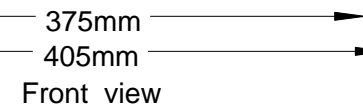
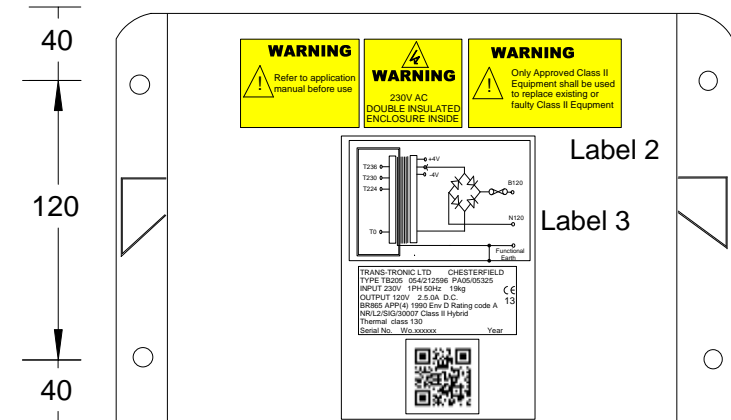
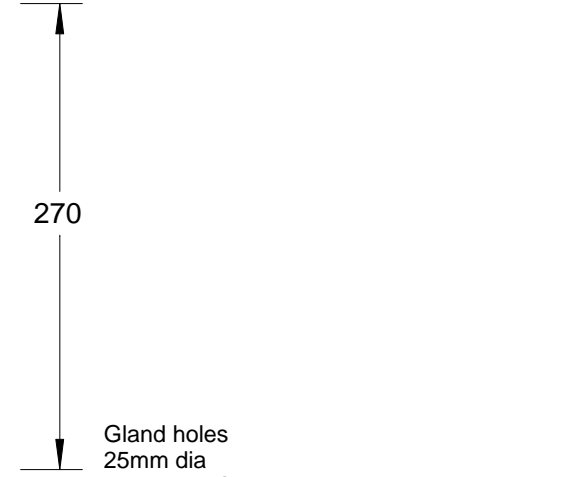

Front view

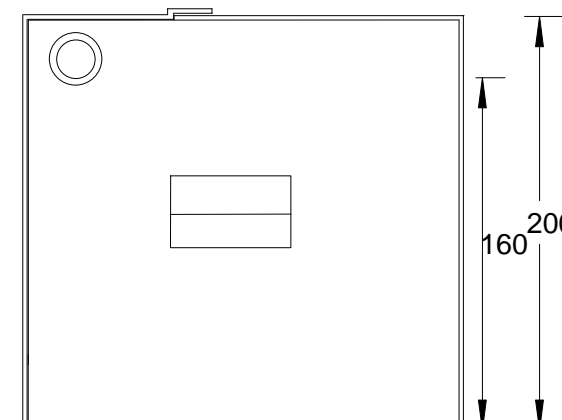

Side view

Item	Description	Part No.
Case 1	Trans/Rect case	21-CASE-TR2DG
Trans 1	230/120v 2.5A classII	TT4487
Cover 1	TR2 Poly carb	21-TR2-COV1
Fuse1	Rectifier Fuse GSA25	01-25A-GSA
Label 1	230VClassIITR1top	02-class2-230TR1top
Label 2	230VClassIITR1front	02-Class2-230TR1front
Label 3	Circuit diagram + Rating plate	TB205CD+RP
Label 4	230VClassII internal	02-class2-230int
Label 5	TRANS-TRONIC	02-Trans-Tronic

Trans-Tronic Ltd
Whitting Valley Road, Chesterfield, S41 9EY
Tel: 01246 264260 Fax: 01246 455281

TITLE GA drawing for ClassII Hybrid points machine
230/120V @ 2.5A cont DC 054/212596 PA05/05325

SIZE A4	DATE 01/08/2013	DWG NO A4-TB205-GA	REV 3
SCALE		SHEET 1 of 1	