

Certificate no. 4001132

TB167
PRODUCT DATA
054/212604
PA05/05325

Whitting Valley Road, Old Whittington, Chesterfield, Derbyshire S41 9EY UK
 Telephone: +44 (0) 1246 264260 Fax: +44 (0) 1246 455281
 Web: www.trans-tronic.co.uk E mail: sales@trans-tronic.co.uk

COIL WINDING – TRANSFORMER DESIGN & MANUFACTURE

Class II Hybrid FSP Isolating Transformer with copper conductors
NR/L2/SIGELP/30007 650/110V 3x350VA 1x500VA 2x 50/60v 3A DC



Dimensions	340x280x 280mm high	Weight	49Kg	BS381c shade 632	Dark Admiralty Grey
General arrangement drawing	GA-TB167 overleaf			O&M Manual : Trans-Tronic ClassII-Hybrid-FSP- Tx O&M	
Primary (Input) ClassII	T0-T605-T650-T695			Secondary (output) ClassI 3 x t0-t107-t110-t113-t140 @ 350VA 1 x t0-t107-t110-t113-t140 @ 500VA 2x 50/60v 3A DC	
Rating Full load	4x 350VA 1x 500VA 2x 50/60v 3A DC				
Intermittent then	4x 420VA 1x 600VA 2x 50/60v 3A DC for 15 minutes in each hour 4x 350VA 1x 500VA 2x 50/60v 3A DC for remaining 45 minutes				
Primary terminals	Screw up clamp 0.5 -10mm ²		Secondary terminals Screw up clamp 0.5-10mm ²		
Functional earth	Screw up clamp 0.5-10mm ²		Enclosure IP32		
Efficiency	95%	Regulation	3.3%	Impedance	3.5%
No Load losses	25 watts			Full load losses 90 watts	
Primary resistance @ 20°C	3.1ohms @ 650V			Secondary resistance @ 20°C 350VA secondary 0.53 ohms @ 110V 500VA secondary 0.35 ohms @ 110V	
Primary Inductance	13mH @ 650V			Secondary Inductance 0.40mH @ 110V	
Input current at full load	3.5A @ 605V 3.2A @ 650v 3.0A @ 695V			Output current at full load each secondary 350VA 3.2A @110V 2.5A @ 140V 500VA 4.5A @110V 3.6A @ 140V	
Input current at 120% of full load (15 minutes in each hour)	4.0A @ 605V 3.8A @ 650v 3.5A @ 695V			Output current at 120% full load for each secondary 420VA 3.8A @110V 3.0A @ 140V 600VA 5.4A @110V 3.6A @ 140V	
Peak inrush current	7.1 x FLC (22.6A at 650V)		I _{pt}	3.9 A ² s	X/R ratio 0.8
Prospective short circuit current @ 20°C for 5 seconds	Single 350VA secondary 150A or Single 500VA secondary 220A or all secondary's 350A				
Insulation resistance (500v)	Primary to body >100M ohms		Dielectric strength Primary to body 5.2Kv		Impulse withstand 8Kv
	Secondary to body >100M ohms		Secondary to body 2.8Kv		
	Primary to secondary body >100M ohms		Primary to secondary body 5.2Kv		
Recommended input fuse protection	BS88 & 10x38 gG IEC 60269-1 &-2 4A				
Operational temperature range	-20°C to +60°C			Humidity	Up to 100% RH
Altitude	<2000 metres above sea level			Issue 1	15/02/2016

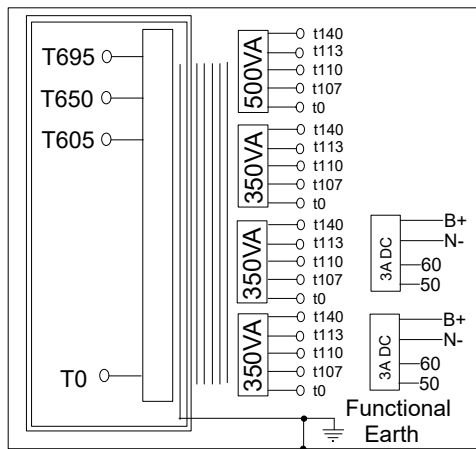

Primary Terminals
0.5-10mm² cable

Secondary Terminals
0.5-10mm² cable

Functional Earth
0.5-10mm² cable

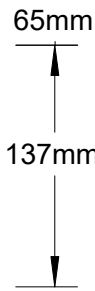

Cover 1 Case 1

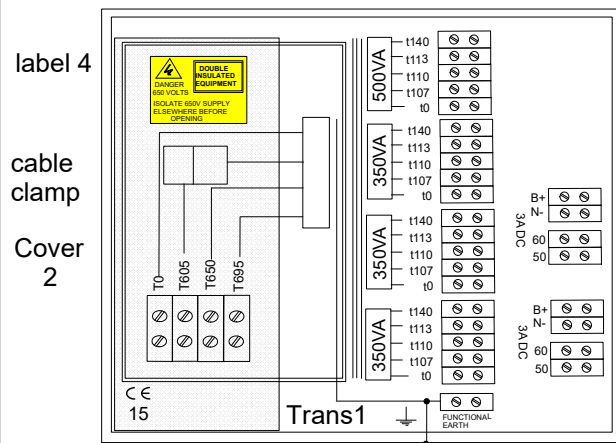

Internal view with case lid removed

Combined
carrying handle
and lifting point

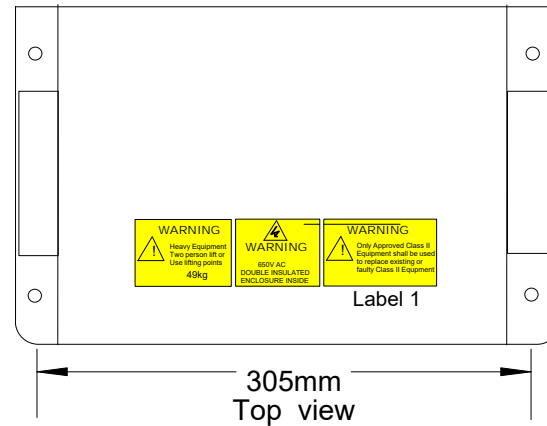
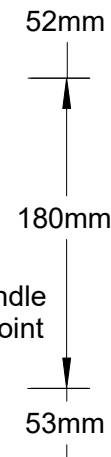

305mm
Top view

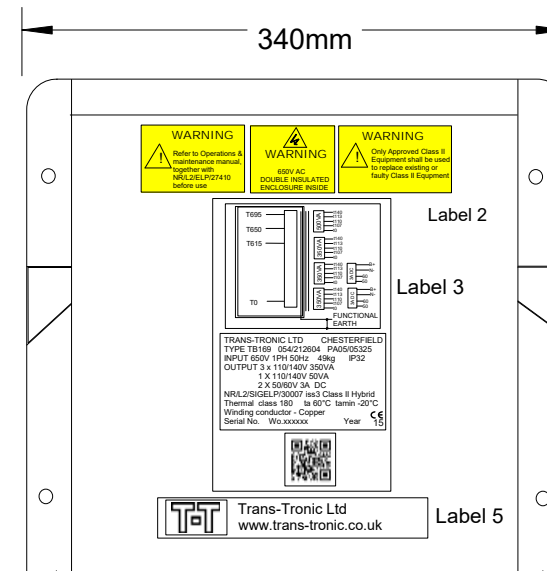

310mm
Front view

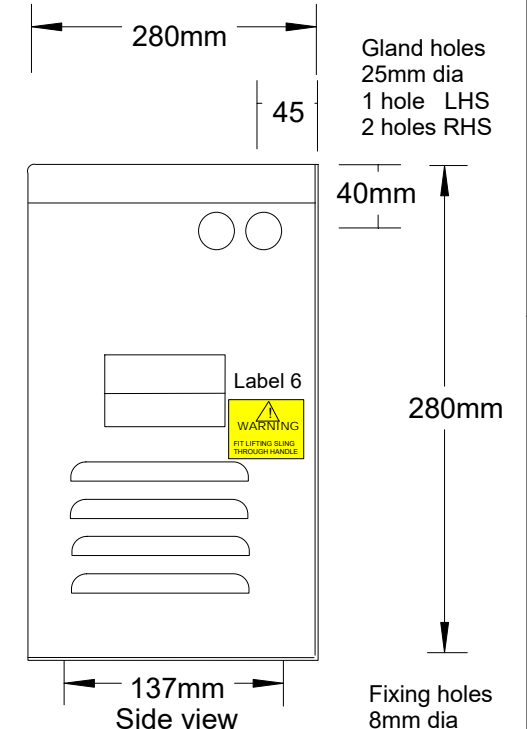

137mm
Side view

Item	Description	Part No.
Case 1	Transformer case	21-CASE-P5DG
Trans 1	650/110v 2050va classII	TT4831
Cover 1	P5class2 Poly carb	21-P5-COV1
Cover 2	P5 Mylar side layer	21-P5-COV2
Label 1	650VClassIIP5top	02-class2-TB167top
Label 2	650VClassIIP5front	02-Class2-650P5Front
Label 3	Circuit diagram + Rating plate	TB167 CD+RP
Label 4	650VClassII internal	02-class2-650int
Label 5	Trans-Tronic	02-trans-tronic
Label 6	Lifting warning	02-class2-lifting



Trans-Tronic Ltd Whitting Valley Road, Chesterfield, S41 9EY Tel: 01246 264260 Fax: 01246 455281			
TITLE GA drawing for ClassII Hybrid FSP Isolating transformer 650/110V/140 3 X 350VA + 1X 500VA + 2X 50/60V 3A DC TB167 054/212604 PA05/05325			
SIZE A4	DATE 11/02/2016	DWG NO A4-TB167-GA	REV 1
SCALE NTS	SHEET 1 of 1		